

Technical Data Sheet DC-DC converter P12W180

Parameter	Min.	Max.	Unit	Test conditions
Input voltage	15	110	V	
Output voltage	11,75	12,25	V	
Output current	0	15,5	A	Constant usage
Efficiency	94		%	
Static load regulation, 100% to 10%		0,2 %	V	Typical
Static line regulation (10% load)		<0,01 %	V	
Output noise (B=20MHz)		30	mVpp	Typical
Galvanic Isolation				No
Output short circuit protection				Yes
Output current limit		15,5	A	
Enable voltage	+15	+110	V	Referred to "IN."
Input reverse polarity protection				External fuse (optional)
Output series diode				No
Output crowbar protection		20	V	Yes
LED Power ON				Yes
Thermal protection			°C	Yes
External temperature range	-40	+55	°C	
Storage temperature range	-55	+105	°C	
Protection degree				IP67
Directives		89/336/CEE - Electromagnetic compatibility 73/23/CEE - Low voltage		
Reference norms		CEI EN 61204: 2001-07 UNI EN 12895: 2002-03		

IMPORTANT NOTE:
Wrong connection damages the converter.
PARALLEL CONNECTION IS NOT POSSIBLE.

The input ENABLE must be connected to positive battery voltage, typically after the key switch

Scale 1:1



Type	P12W180	S.n.	A 02/10
Input	15 - 110 Vdc	Output	12V 15A

Posizione	Funzione
1	ENABLE
2	V/+
3	V/-
4	Vo-
5	Vo+

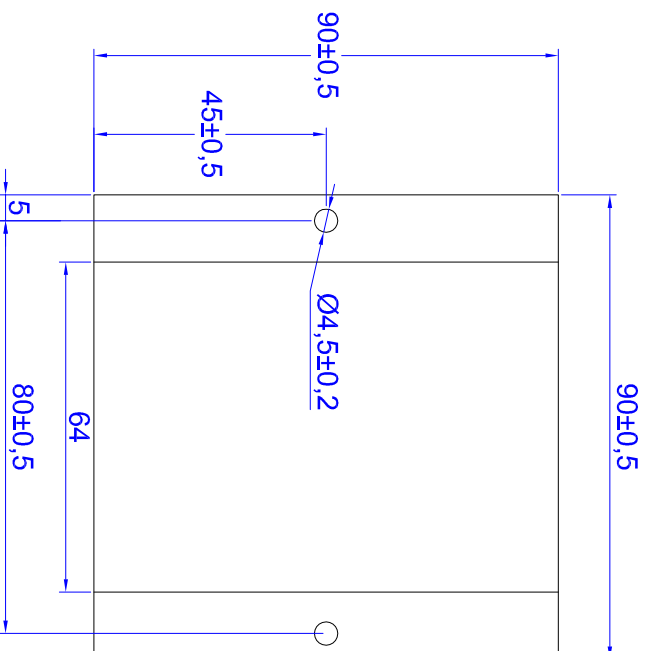
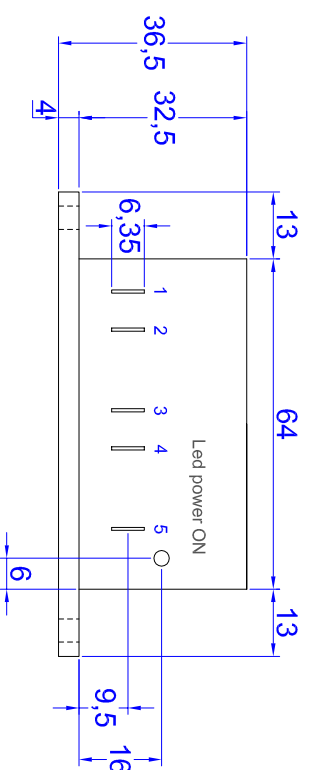

UNLESS OTHERWISE SPECIFIED,
DIMENSIONS ARE IN MILLIMETERS
TOLERANCES ARE:
FRACTIONS DECIMALS
MILLIMETERS

NAME	SIGNATURE	DATE	FINISH	BEAR AND BREAK SHAPED EDGES
ING. Marchionni		24/11/10		
ING. Rohrer	<i>or</i>	24/11/10		

Dwg. No.		Revision	
DC-DC P12W180 - rev.3		03	

