

# Technical Data Sheet DC-DC converter P24W300

Parameter	Min.	Max.	Unit	Test condition
Input voltage	28	110	V	
Output voltage	23,7	24,3	V	
Output current	0	13	A	Constant
Efficiency	94		%	
Static load regulation, 100% a 10%		0,2 %	V	Typical
Static line regulation (10% load)		<0,01 %	V	
Output noise (B=20MHz)		30	mVpp	Typical
Galvanic isolation				No
Output short circuit protection				Yes
Output current limit		13	A	V <sub>in</sub> =28-110V V <sub>out</sub> =24V
Enable voltage	+20	+110	V	Referred to "IN-"
Input reverse polarity protection				Ext: fuse (optional)
Output series diode				No
Output crowbar protection		30	V	Yes
Led Power ON				Yes
Thermal protection			°C	Yes
External temperature range	-40	+55	°C	
Storage temperature range	-55	+105	°C	
Protection degree				IP67
Directives	89/336/CEE - Electromagnetic compatibility 73/23/CEE - Low tension			
Reference norms	CEI EN 61204: 2001-07 UNI EN 12895: 2002-03			

**IMPORTANT NOTE:**  
Wrong connection can damage the converter  
**PARALLEL CONNECTION NOT POSSIBLE**

The input ENABLE must be connected to positive battery voltage, typically after the key switch

Scale 1:1



cod. barre  
cod. barre  
cod. barre  
cod. barre  
cod. barre  
cod. barre  
cod. barre  
cod. barre  
cod. barre  
cod. barre

**Type** P24W300 **S.n.** A 10/09  
**Input** 28 - 110 Vdc **Output** 24V 12,5A

Position	Function
1	ENABLE
2	V <sub>I+</sub>
3	V <sub>I-</sub>
4	V <sub>O-</sub>
5	V <sub>O+</sub>

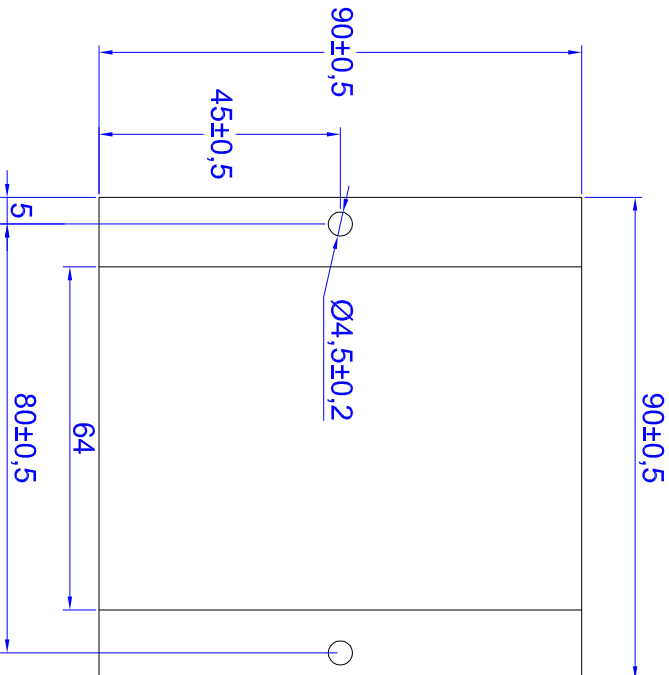
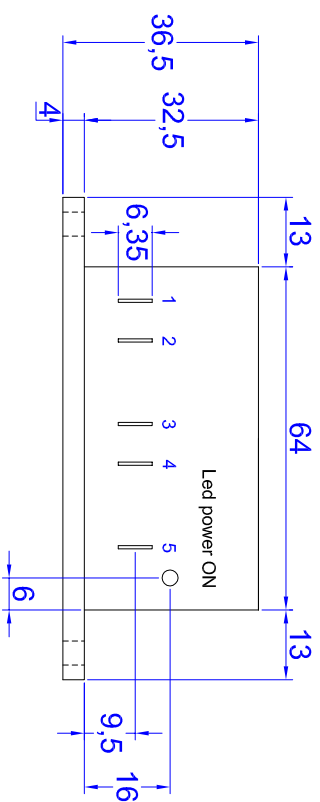

NAME	SIGNATURE	DATE	DESIGN AND BREAK SHARP EDGES
ING. MARCHIONI		24/11/10	
ING. ROHRER		24/11/10	

DO NOT SCALE DRAWING	REVISION
Technical Data Sheet P24W300	01



**DC-DC P24W300 - rev.3**

SCALE: A4